

**Sale Name:** EASTERN CLARK COUNTY FARM

**LOT 2 - Tract 2**

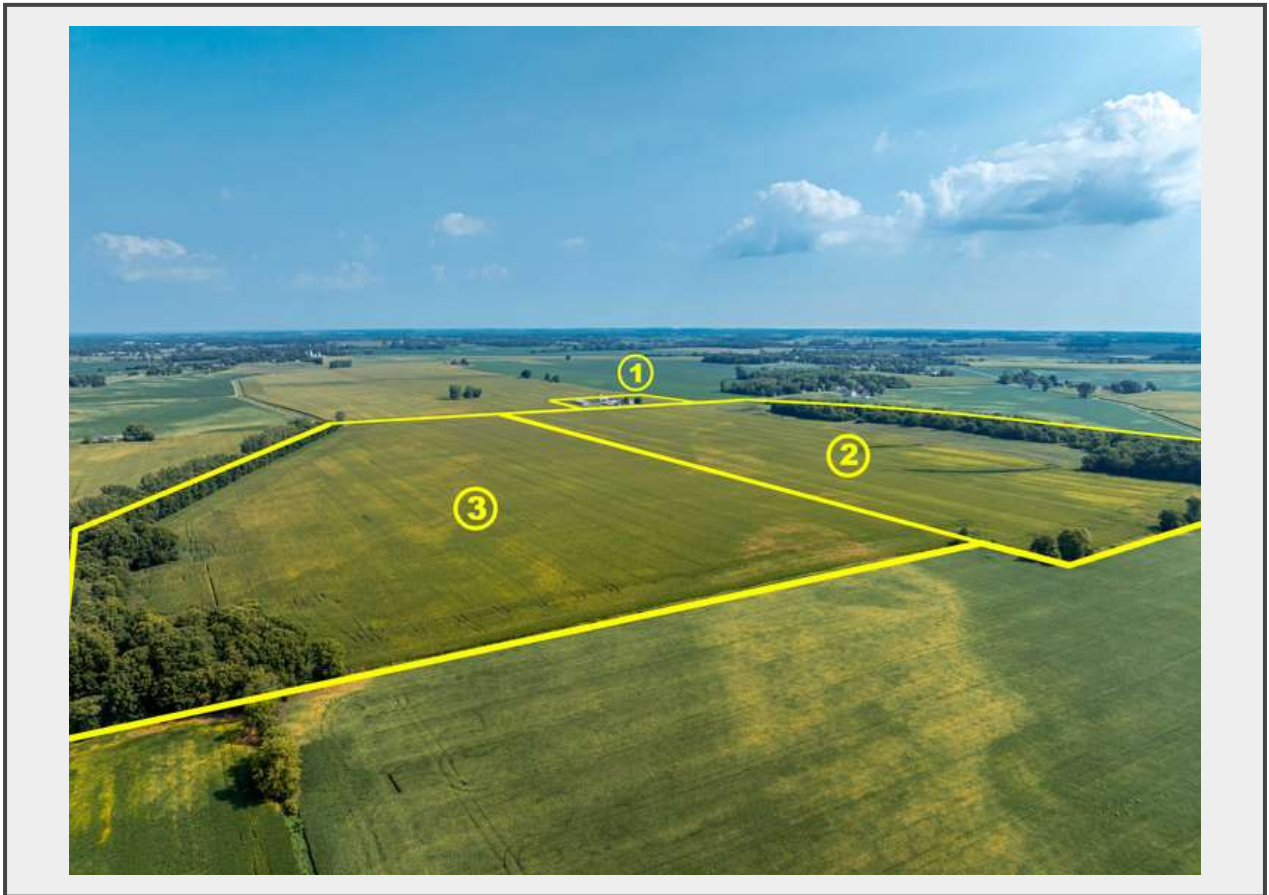

### Description

E. Pitchin Road, South Charleston, Ohio

- 80.0 acres with 52.9 tillable acres & up to 13 pasture acres that can easily be converted to tillable acres
- 14 wooded acres, great to subdivided into multiple premier building lots or for hunting & recreational uses
- Newer 30'x40' metal pole barn within the woods

**Quantity:** 1



<https://bid.sheridanteam.com/>